

# Series QR2-F Heat-resistant

- Straight fitting
- External thread
- M5
- push-in fitting
- Ø 4
- QR2-F-RPN



Working pressure min./max.	-0,95 ... 16 bar
Ambient temperature min./max.	-20 ... 150 °C
Weight	See table

## Technical data

Part No.	Port G	Port D	Delivery unit	Weight
1823373089	M5	Ø 4	25 piece	0,006 kg
1823373090	M5	Ø 6	25 piece	0,01 kg
1823373091	G 1/8	Ø 4	25 piece	0,005 kg
1823373092	G 1/8	Ø 6	25 piece	0,011 kg
1823373093	G 1/8	Ø 8	25 piece	0,012 kg
1823373094	G 1/4	Ø 4	25 piece	0,012 kg
1823373095	G 1/4	Ø 6	25 piece	0,015 kg
1823373096	G 1/4	Ø 8	10 piece	0,016 kg
1823373097	G 1/4	Ø 10	10 piece	0,026 kg
R412007625	G 1/4	Ø 12	10 piece	0,027 kg
1823373098	G 3/8	Ø 8	10 piece	0,021 kg
1823373099	G 3/8	Ø 10	10 piece	0,028 kg
R412007730	G 1/2	Ø 12	10 piece	0,041 kg

## Technical information

The series QR1 (plastic) and QR2 (metal) can not be combined  
Thread seal with captive O-ring

For further information about assembling and tolerances of adaptable tubing can be found in the "Technical information" document (available in the MediaCentre).

## Technical information

Material	
Housing	Brass, nickel-plated
Seal	Fluorocaoutchouc
Tooth lock washer	Stainless steel
Release ring	Brass, nickel-plated
Thread	Brass, nickel-plated

## Dimensions

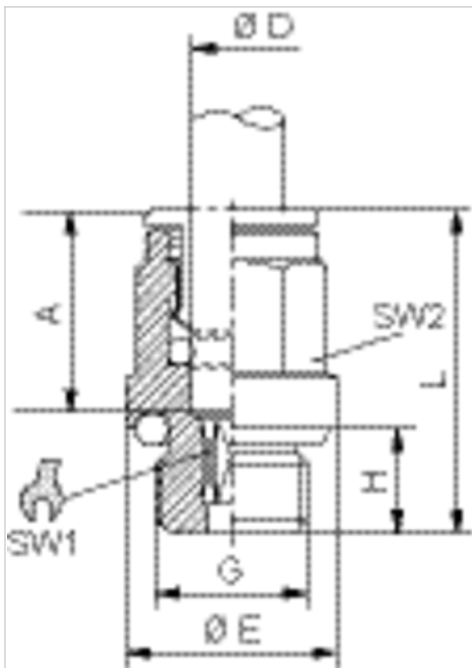

## Dimensions

Part No.	Port D	Port G	Ø E	H	L	A*	SW1	SW2
1823373089	Ø 4	M5	9	4	20.5	15	2.5	–
1823373090	Ø 6	M5	10.5	4	22.5	16	2.5	–
1823373091	Ø 4	G 1/8	13.5	6	20	15	2.5	9
1823373092	Ø 6	G 1/8	13.5	6	24	16	4	11
1823373093	Ø 8	G 1/8	13	6	26.5	18	5	13
1823373094	Ø 4	G 1/4	17	8	21	15	2.5	9
1823373095	Ø 6	G 1/4	17	6.5	22.5	15	4	11
1823373096	Ø 8	G 1/4	17	8	25	18	6	13
1823373097	Ø 10	G 1/4	16	8	29.5	19	7	16
R412007625	Ø 12	G 1/4	16	6.5	30	19	7	18
1823373098	Ø 8	G 3/8	20	9	25	18	6	13
1823373099	Ø 10	G 3/8	21	9	29.5	19	8	16
R412007730	Ø 12	G 1/2	24	11	31	20	10	18

UK Office  
5 Caulside Drive  
Antrim  
BT41 2DU  
United Kingdom  
+44 (0) 28 9448 1808

European Office  
Unit 6, Saint Anthony's Business Park  
Dublin  
D22 VW95  
Ireland  
+353 (0) 1 4373653



\*