

# Series QR2-C, stainless steel

- Elbow fitting, conical
- External thread
- R 1/4
- push-in fitting
- Ø 4
- QR2-C-RVT
- suitable for use in food processing



Working pressure min./max.	-0,95 ... 16 bar
Ambient temperature min./max.	-20 ... 150 °C
Weight	See table

## Technical data

Part No.	Port G	Port D	Delivery unit	Weight
2544104180	R 1/8	Ø 4	2 piece	0,011 kg
2544106180	R 1/8	Ø 6	2 piece	0,021 kg
2544108180	R 1/8	Ø 8	2 piece	0,022 kg
2544104140	R 1/4	Ø 4	2 piece	0,025 kg
2544106140	R 1/4	Ø 6	2 piece	0,027 kg
2544108140	R 1/4	Ø 8	2 piece	0,028 kg
2544110140	R 1/4	Ø 10	2 piece	0,037 kg
2544110380	R 3/8	Ø 10	1 piece	0,034 kg
2544112380	R 3/8	Ø 12	1 piece	0,066 kg
2544112120	R 1/2	Ø 12	1 piece	0,067 kg

## Technical information

The series QR1 (plastic) and QR2 (metal) can not be combined

For further information about assembling and tolerances of adaptable tubing can be found in the "Technical information" document (available in the MediaCentre).

## Technical information

### Material

Housing	Stainless steel
Seal	Fluorocautchouc
Tooth lock washer	Stainless steel
Release ring	Stainless steel
Thread	Stainless steel

## Dimensions

### Dimensions

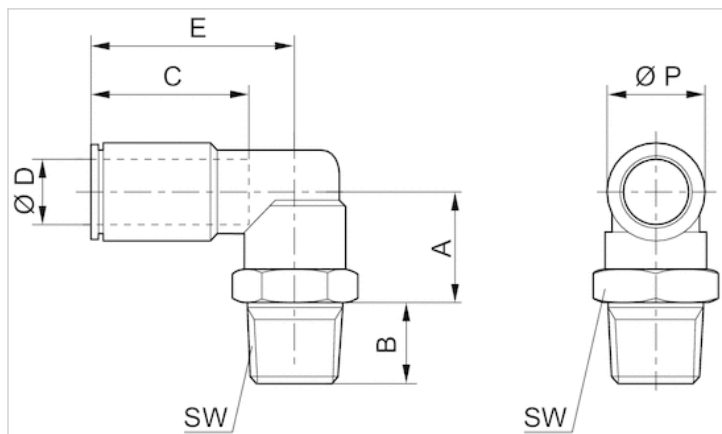

### Dimensions

Part No.	Port D	Port G	A	B	C	E	SW	Ø P
2544104180	Ø 4	R 1/8	13	7	15	20	13	9
2544106180	Ø 6	R 1/8	13	7	16	21	13	11
2544108180	Ø 8	R 1/8	13	7	18	24	13	13
2544104140	Ø 4	R 1/4	14	11	15	20	14	9
2544106140	Ø 6	R 1/4	14	11	16	21	14	11
2544108140	Ø 8	R 1/4	14	11	18	24	14	13
2544110140	Ø 10	R 1/4	14.5	11	17	26.5	16	16
2544110380	Ø 10	R 3/8	15.5	11.5	17	25.5	17	16
2544112380	Ø 12	R 3/8	19	11.5	18.5	28	20	18
2544112120	Ø 12	R 1/2	19.5	14	18.5	28	22	18