

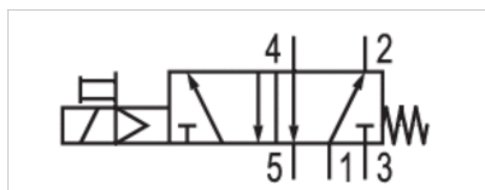









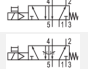

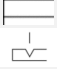
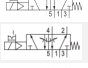
5/2-directional valve, Series CD20-PI

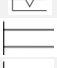
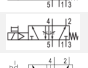
- ISO 5599-2
- ISO 2
- 5/2
- With spring return
- $Q_n = 2700 \text{ l/min}$
- Compressed air connection output Base plate DIN ISO 5599 size 2
- Electrical connection Plug, ISO 5599-2
- Manual override without detent

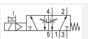

Version	Spool valve
Sealing principle	Soft sealing
Blocking principle	Single base plate principle
Connection type	Plate connection
Standards	ISO 5599-2, ISO 2
Connector standard	ISO 5599-2
Working pressure min./max.	0 ... 10 bar
Control pressure min./max.	2,7 ... 10 bar
Ambient temperature min./max.	-20 ... 50 °C
Medium temperature min./max.	0 ... 50 °C
Medium	Compressed air
Max. particle size	50 µm
Oil content of compressed air	0 ... 5 mg/m ³
Nominal flow Q_n	2700 l/min
Compressed air connection	according to ISO 5599
Protection class with connection	IP65
Protection class according to NEMA	NEMA 4
Protective circuit	Z-diode
Reverse polarity protection	Protected against polarity reversal
LED status display	Green
Nominal resistance	288 Ω
Duty cycle	100 %
Typ. switch-on time	22 ms
Typ. switch-off time	50 ms
Mounting screw	with hexagon socket
Mounting screw tightening torque	4 Nm
Weight	0,59 kg

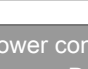
Technical data

Part No.		MO	Operational voltage DC	Voltage tolerance DC
2612081100			24 V	-10% / +10%
2612081110			24 V	-10% / +10%
2612081120			24 V	-10% / +10%
2612081130			24 V	-10% / +10%
2612091100			24 V	-10% / +10%
2612091110			24 V	-10% / +10%
2612091120			24 V	-10% / +10%
2612091130			24 V	-10% / +10%

Part No.	Power consumption DC	Pilot	Nominal flow 1 ▶ 2	Electrical connection Pilot valve
2612081100	2 W	internal	2700 l/min	Plug ISO 5599-2
2612081110	2 W	internal	2700 l/min	Plug ISO 5599-2
2612081120	2 W	internal	2700 l/min	Plug ISO 5599-2
2612081130	2 W	internal	2700 l/min	Plug ISO 5599-2
2612091100	2 W	external	2700 l/min	Plug ISO 5599-2
2612091110	2 W	external	2700 l/min	Plug ISO 5599-2
2612091120	2 W	external	2700 l/min	Plug ISO 5599-2
2612091130	2 W	external	2700 l/min	Plug ISO 5599-2

Part No.	Protected against polarity reversal	Throttle
2612081100	Protected against polarity reversal	-
2612081110	Protected against polarity reversal	With flow control
2612081120	Protected against polarity reversal	-
2612081130	Protected against polarity reversal	With flow control
2612091100	Protected against polarity reversal	-
2612091110	Protected against polarity reversal	With flow control
2612091120	Protected against polarity reversal	-
2612091130	Protected against polarity reversal	With flow control

Technical information

The min. control pressure must be adhered to, since otherwise faulty switching and valve failure may result!

The pressure dew point must be at least 15 °C under ambient and medium temperature and may not exceed 3 °C .

The oil content of compressed air must remain constant during the life cycle.

Use only the approved oils from AVENTICS. Further information can be found in the "Technical information" document (available in the MediaCentre).

Technical information

Housing	Aluminum Polyamide, fiber-glass reinforced
Seals	Acrylonitrile butadiene rubber

Dimensions

Dimensions

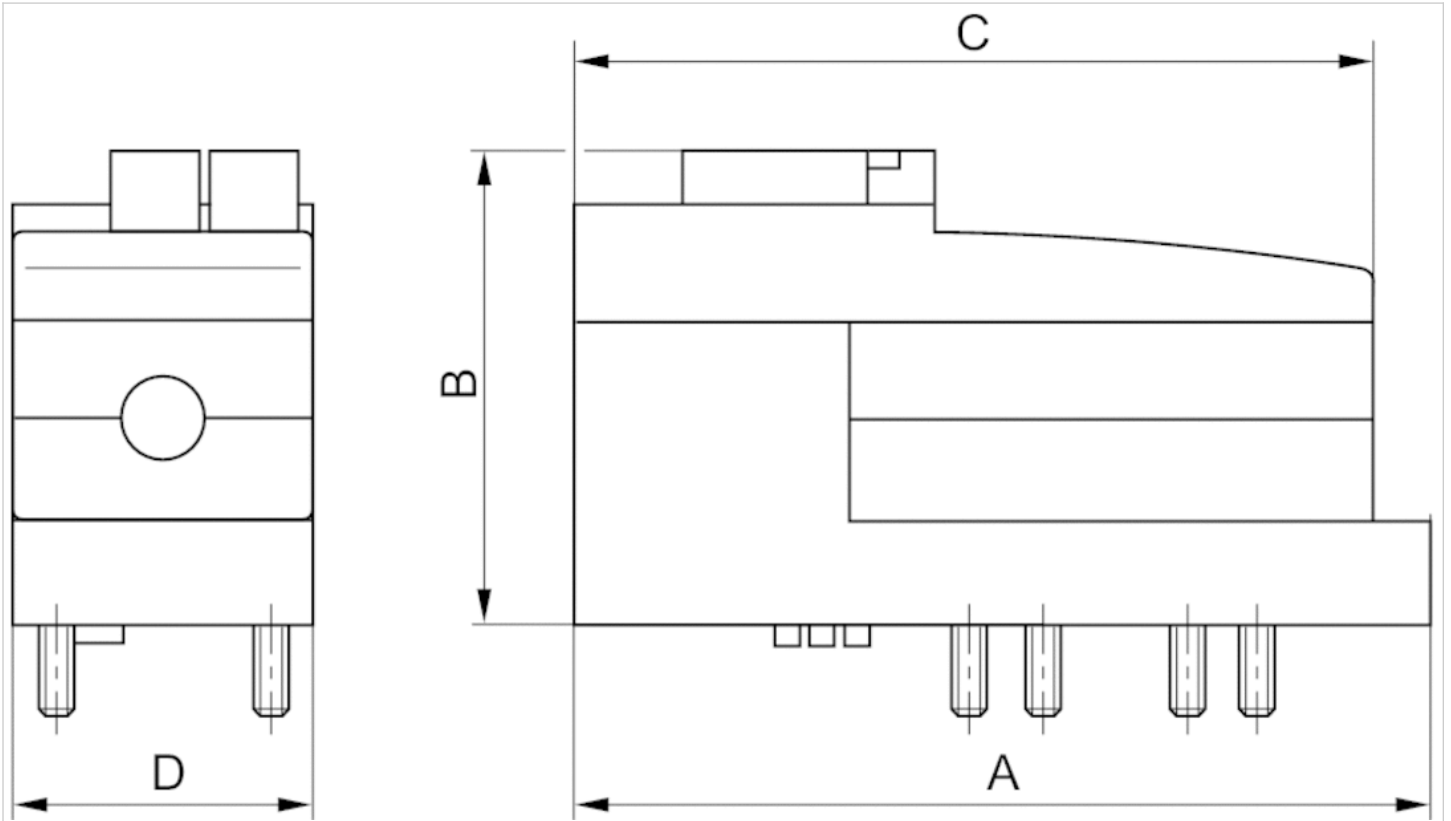

Dimensions

Part No.	A	B	C	D
2612081100	143	78.5	135	50
2612081110	143	78.5	135	50
2612081120	143	78.5	135	50
2612081130	143	78.5	135	50
2612091100	143	78.5	135	50
2612091110	143	78.5	135	50
2612091120	143	78.5	135	50
2612091130	143	78.5	135	50