

Series EBE

- electrical control, compact form
- with release valve



Version	electrical control, compact form
Activation	Electrically
Working pressure min./max.	3 ... 6 bar
Ambient temperature min./max.	0 ... 50 °C
Medium temperature min./max.	0 ... 50 °C
Medium	Compressed air
Max. particle size	5 µm
Oil content of compressed air	0 ... 1 mg/m ³
Protection class With valve plug connector	IP65
Duty cycle according to DIN VDE 0580 standard	100 %
Max. vacuum level at p.opt	83 %
Voltage tolerance DC	-10% / +10%
Weight	See table



Technical data

Part No.	Type	Nozzle Ø	Compressed air connection	Vacuum connection+
0821305032	EBE-ET-07-NC	0,7 mm	G 1/4	G 1/4
0821305033	EBE-ET-10-NC	1 mm	G 1/4	G 1/4
0821305035	EBE-ET-07-NC	0,7 mm	G 1/4	G 1/4
0821305036	EBE-ET-10-NC	1 mm	G 1/4	G 1/4
0821305041	EBE-ET-07-NC	0,7 mm	G 1/4	G 1/4
0821305042	EBE-ET-10-NC	1 mm	G 1/4	G 1/4

Part No.	Port exhaust	Operationalvoltage DC	Operationalvoltage AC 50 Hz	Power consumption Solenoid valve DC
0821305032	G 1/4	24 V	-	4,8 W
0821305033	G 1/4	24 V	-	4,8 W
0821305035	G 1/4	-	230 V	-
0821305036	G 1/4	-	230 V	-
0821305041	G 1/4	-	-	-
0821305042	G 1/4	-	-	-

Part No.	Switch-on power AC 50 Hz	Holding power AC 50 Hz	Max. suction capacity
0821305032	-	-	23 l/min
0821305033	-	-	39 l/min
0821305035	12,6 VA	9,7 VA	23 l/min
0821305036	12,6 VA	9,7 VA	39 l/min
0821305041	-	-	23 l/min
0821305042	-	-	39 l/min

Part No.	Air consumption at p.opt.	Electr. connection	Weight
0821305032	33 l/min	Plug, ISO 6952, form B	0,28 kg
0821305033	54 l/min	Plug, ISO 6952, form B	0,28 kg
0821305035	33 l/min	Plug, ISO 6952, form B	0,28 kg
0821305036	54 l/min	Plug, ISO 6952, form B	0,28 kg
0821305041	33 l/min	Plug, ISO 6952, form B	0,18 kg
0821305042	54 l/min	Plug, ISO 6952, form B	0,18 kg

Technical information

Note: All data refers to an ambient pressure of 1.013 bar and an ambient temperature of 20 °C .
The pressure dew point must be at least 15 °C under ambient and medium temperature and may not exceed 3 °C .

Technical information

Material	
Housing	Aluminum, anodized
Nozzle	Brass

Dimensions

For valve plug connectors according to ISO 6952 (form B)

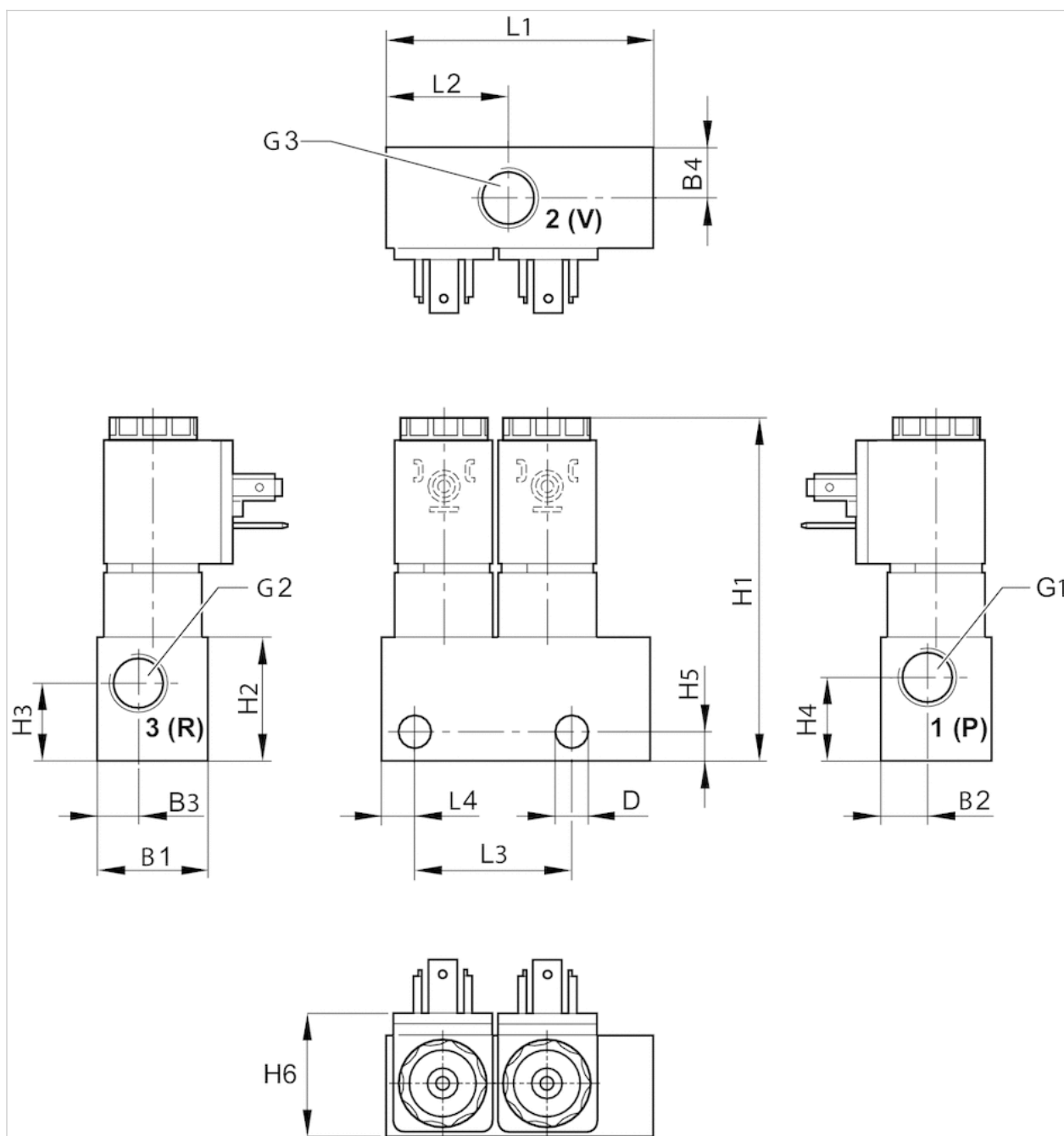

Dimensions

Part No.	G1	G2	G3	B1	B2	B3	B4	D	H1	H2	H3	H4	H5	H6	L1	L2	L3	L4
0821305032	G 1/4x10	G 1/4x11	G 1/4x11	24	10	9	12	Ø 7,5	~82	30	19	20	7	29.6	60	28	35	7.5
0821305033	G 1/4x10	G 1/4x11	G 1/4x11	24	10	9	12	Ø 7,5	~82	30	19	20	7	29.6	60	28	35	7.5
0821305035	G 1/4x10	G 1/4x11	G 1/4x11	24	10	9	12	Ø 7,5	~82	30	19	20	7	29.6	60	28	35	7.5
0821305036	G 1/4x10	G 1/4x11	G 1/4x11	24	10	9	12	Ø 7,5	~82	30	19	20	7	29.6	60	28	35	7.5
0821305041	G 1/4x10	G 1/4x11	G 1/4x11	24	10	9	12	Ø 7,5	--	30	19	20	7	29.6	60	28	35	7.5
0821305042	G 1/4x10	G 1/4x11	G 1/4x11	24	10	9	12	Ø 7,5	--	30	19	20	7	29.6	60	28	35	7.5

Diagrams

Vacuum p_2 depending on working pressure p_1

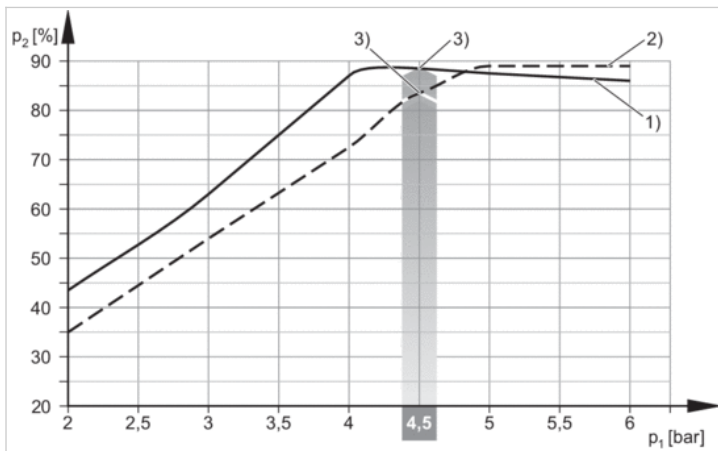

- 1) DMR Ø nozzle 0.7 mm
- 2) DMR Ø nozzle 1.0 mm
- 3) optimum working pressure

Suction capacity q_s depending on working pressure p_1

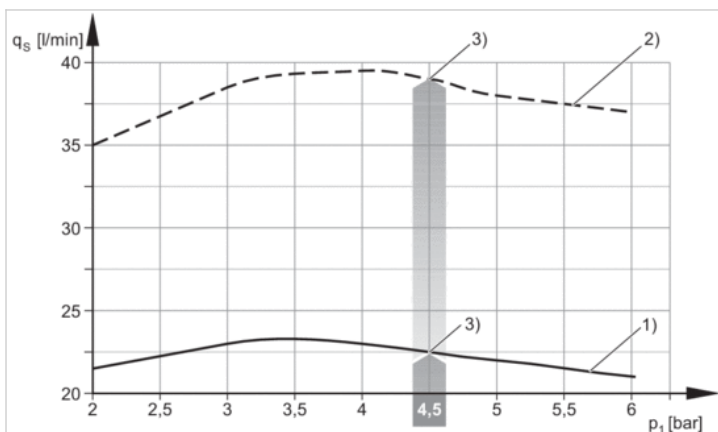

- 1) DMR Ø nozzle 0.7 mm
- 2) DMR Ø nozzle 1.0 mm
- 3) optimum working pressure

Evacuation time t_E depending on vacuum p_2 for 1 L volume (with optimal operating pressure)

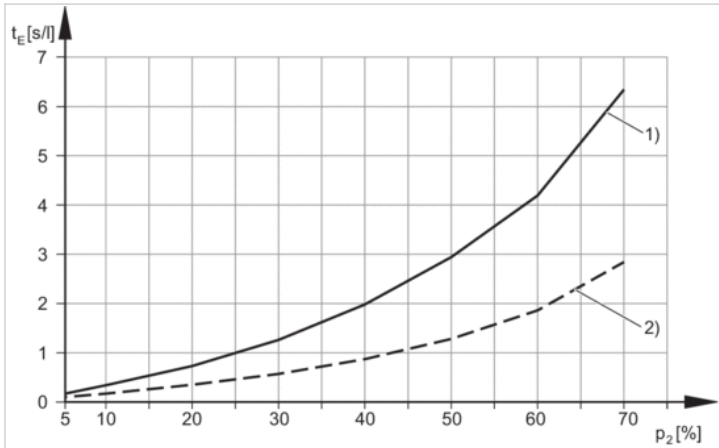

- 1) DMR Ø nozzle 0.7 mm
- 2) DMR Ø nozzle 1.0 mm

Air consumption q_v depending on working pressure p_1

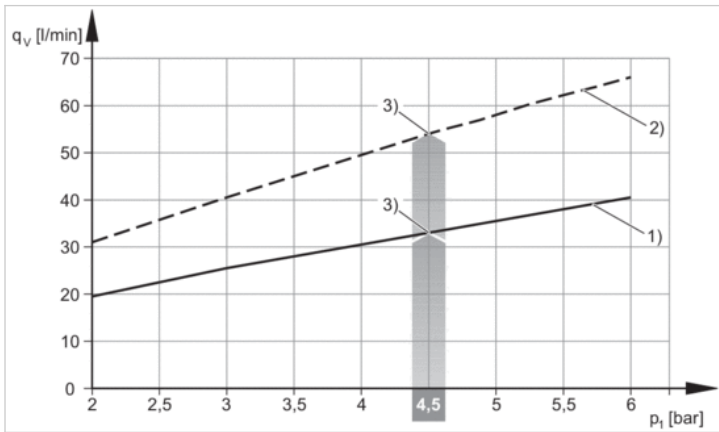

- 1) DMR Ø nozzle 0.7 mm
- 2) DMR Ø nozzle 1.0 mm
- 3) optimum working pressure